

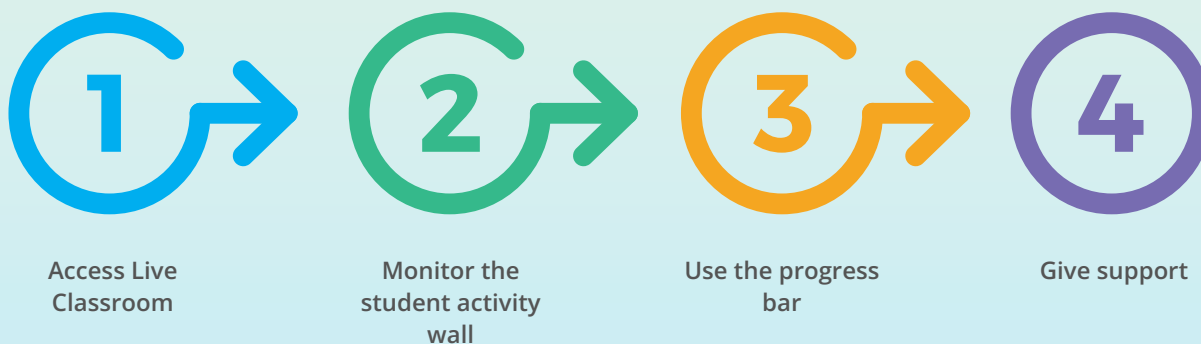

See exactly what your students are working on in IXL in real time, whether they're in the classroom or at home! Live Classroom is perfect for:

- Monitoring whole class activity at a glance
- Helping students get back on track
- Inspiring friendly competition or class-wide collaboration

## Steps to successful implementation



## 1 Access Live Classroom

Visit the **My IXL** tab and click on **Live Classroom** under Engagement tools.

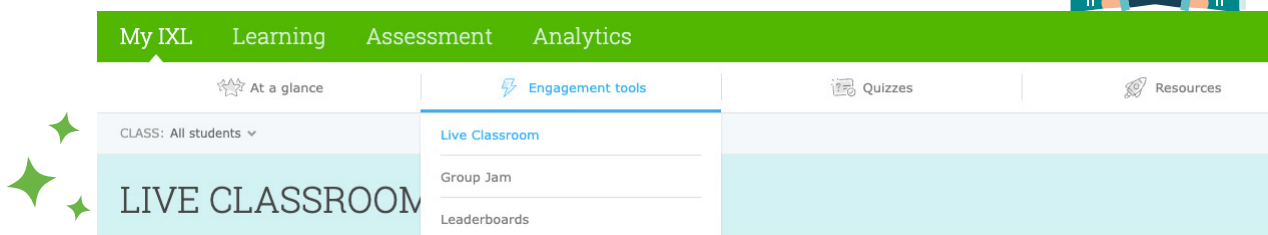

## 2

## Monitor the student activity wall

Each student actively working in IXL appears on a tile. Check their tile to see what individual students are working on during independent or at-home study. Each tile shows you:

- What skill the student is working on
- How many questions they've answered
- Progress bar (showing whether the last 5 questions were answered correctly or incorrectly)
- SmartScore (the blue number on each tile)
- Activity status

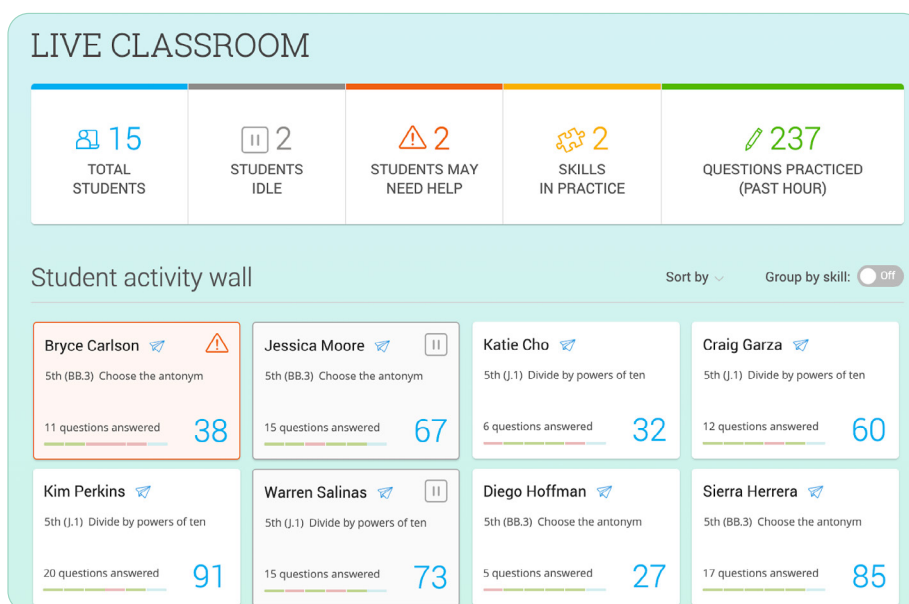

Tiles will change color according to a student's activity status. Students with white tiles are actively working on the noted IXL skill.

You can offer additional support to students with a **red** tile; these students have answered several recent questions incorrectly.

Students with a **gray** tile haven't answered a question in a while; you can intervene to help them adjust their focus and get back on track.

### Tip:

For small group instruction, toggle **Group by skill** to show students working on the same skill. You can also **filter** students to see all active students or active students in a single class.

### 3 Use the progress bar

Click on the red and green progress bar to see the five most recent questions a student has worked through, along with their answers. This way, you can identify where students are struggling. We recommend focusing on students who have:

- Low SmartScores and a high number of questions answered
- Several red lines indicating missed questions in their progress bar

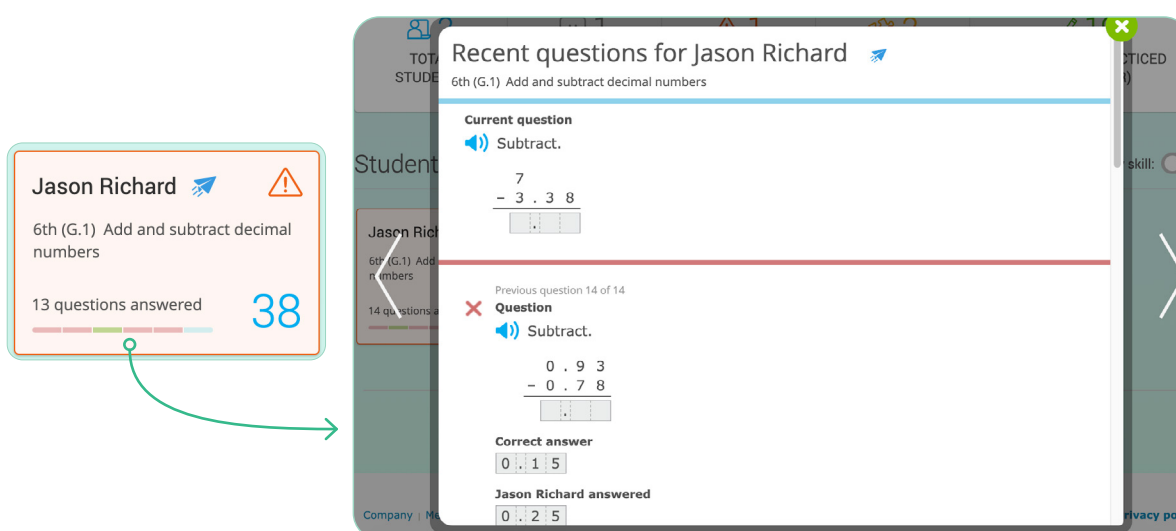

**Jason Richard** 

6th (G.1) Add and subtract decimal numbers

13 questions answered **38**

**Recent questions for Jason Richard**  
6th (G.1) Add and subtract decimal numbers

**Current question**  
Subtract.

$$\begin{array}{r} 7 \\ - 3.38 \\ \hline \end{array}$$

**Previous question 14 of 14**  
**Question**  
Subtract.

$$\begin{array}{r} 0.93 \\ - 0.78 \\ \hline \end{array}$$

**Correct answer**  
0.15

**Jason Richard answered**  
0.25

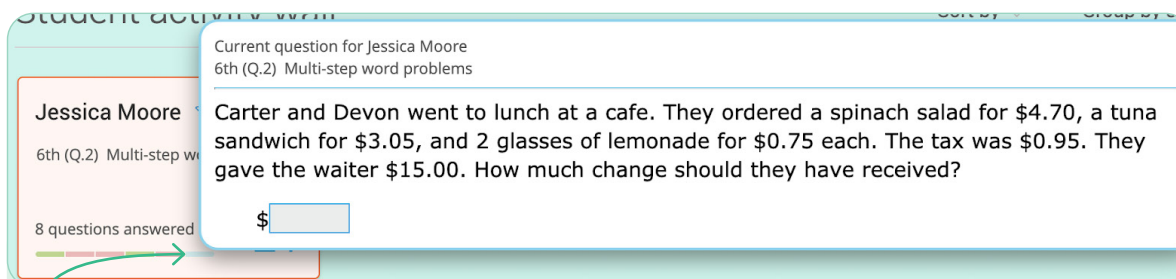

**Jessica Moore**

6th (Q.2) Multi-step word problems

8 questions answered

**Current question for Jessica Moore**  
6th (Q.2) Multi-step word problems

Carter and Devon went to lunch at a cafe. They ordered a spinach salad for \$4.70, a tuna sandwich for \$3.05, and 2 glasses of lemonade for \$0.75 each. The tax was \$0.95. They gave the waiter \$15.00. How much change should they have received?

\$

Hover over the blue bar to see which question they're currently working on.



## 4 Give support

The blue “send” icon next to each student’s name allows you to send Live Messages directly to individual students!

You can use this feature to:

- Give tailored support to students who are stuck on a question
- Encourage idle students to continue working
- Provide positive reinforcement to all students

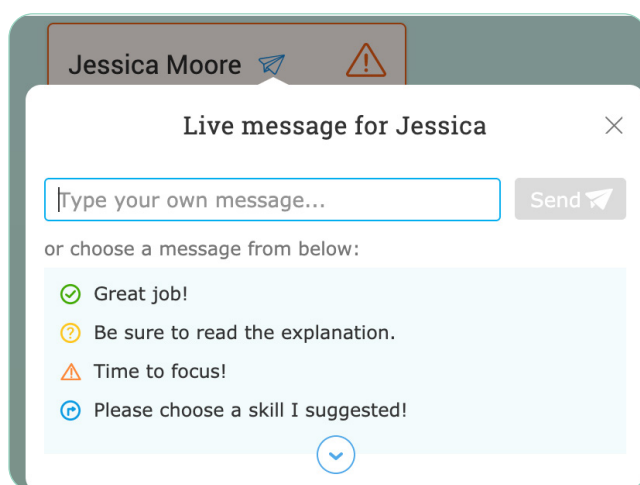

### Live Classroom in action

There are so many ways to use Live Classroom to inspire your students! You can share your screen with students so they can follow along. In the following chart, we’ve included several ideas you can use as students work on the same IXL skill:

Class-wide collaboration	Set a class-wide goal for the number of questions practiced and encourage students to work together to meet it.
Friendly competition	Challenge students to reach mastery (a SmartScore of 100) and shout out students as they get closer to the goal.
Personal milestones	Celebrate students who reach proficiency (a SmartScore of 80+) by the end of the independent study session.

For more ideas on boosting classroom engagement with IXL, visit <https://www.ixl.com/resources/classroom-engagement>